

\$199,000 - Nhn W Dodge Creek Road, Rexford

MLS® #30047318

\$199,000

Bedroom, Bathroom,
Land on 4.42 Acres

N/A, Rexford, MT

A rare find in the West Kootenai—this private 4.42-acre parcel offers over 130 feet of frontage on beautiful Rush Lake. Surrounded by trees and teeming with wildlife including moose, elk, deer, and turkeys, it's an ideal setting for a cabin, RV, or peaceful retreat. Power is nearby, septic (community) is available, and USFS land is close for even more room to explore.



Essential Information

MLS® #	30047318
Price	\$199,000
Acres	4.42
Type	Land
Sub-Type	Residential
Status	Active

Community Information

Address	Nhn W Dodge Creek Road
Subdivision	N/A
City	Rexford
County	Lincoln
State	MT
Zip Code	59930

Amenities

Utilities	Electricity Available, High Speed Internet Available, Phone Available, Underground Utilities
Is Waterfront	Yes

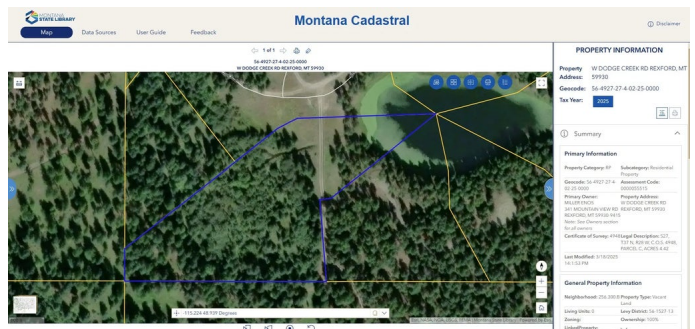

Waterfront Lake, Waterfront

Additional Information

Date Listed May 13th, 2025

Days on Market 48